



Portfolio

solutions for the food industry



Hygienic Design

smooth surfaces and high chemical resistance



Gap-free design with beveled edges
Frameless > no crevices
No welding seams > smooth surfaces

Food-safe seal
Resistant to aggressive acids and lyes
customary to the industry



V4A stainless steel enclosure
Enhanced resistance to corrosion from
cleaning agents containing chloride

IP69k – completely water and dust proof
Completely passive cooling system
Protected plug area

Effective and safe cleaning

By systematically eliminating frames and welded seams our products in the CS series have a completely smooth and easy-to-clean surface, without any joints or grooves. The IPC's enclosure is beveled towards the back so that liquids can flow off and do not accumulate on the enclosure's upper edge. Moreover, special hygienic screws without any grooves are used, unlike slot or Torx screws.

IP69k

CS series products have the protection class rating IP69k, so they are completely water and dust proof.

High level of integration

Integrated in the IPCs are Wifi, Bluetooth®, a power supply unit and a reader (RFID/NFC). In this way the kind of hygiene and leak-tightness risks that can occur with external connections are avoided.

Completely passive cooling system

Systematically implemented climate management, low-voltage components and the elimination of rotating parts that are susceptible to malfunction (e.g. ventilators) ensure high resistance to breakdown. Moreover, no ventilation slits that would affect the leak-tightness are required.

V4A stainless steel enclosure

Compared to V2A stainless steel, V4A stainless steel is much more resistant to corrosion from media containing chloride (e.g. cleaning agents)

Smart mounting solutions

for a maximum of hygiene



The project highlights

- Complete batch tracing using touch screen food IPCs
- 24" screens for excellent usability
- IPCs as interface between software and hardware in the production area
- Smart mounting solutions for a maximum of hygiene
- Touch operations with or without gloves



Highest level of hygiene safety

KIN-Hygienic-Conformity - for the use in hygienically sensitive areas



Cleaning and disinfection

safe and effective with high-pressure cleaners

- Certified IP69k protection
> Safe, fast and effective cleaning with high-pressure cleaners
- V4A stainless steel enclosure
> Resistant to corrosion from cleaners containing chloride
- Food-safe seals
> Resistant to the acids and lyes customary to the industry
- Smooth, crevice-free surfaces without any welded seams
> Convenient and easy wipe-cleaning

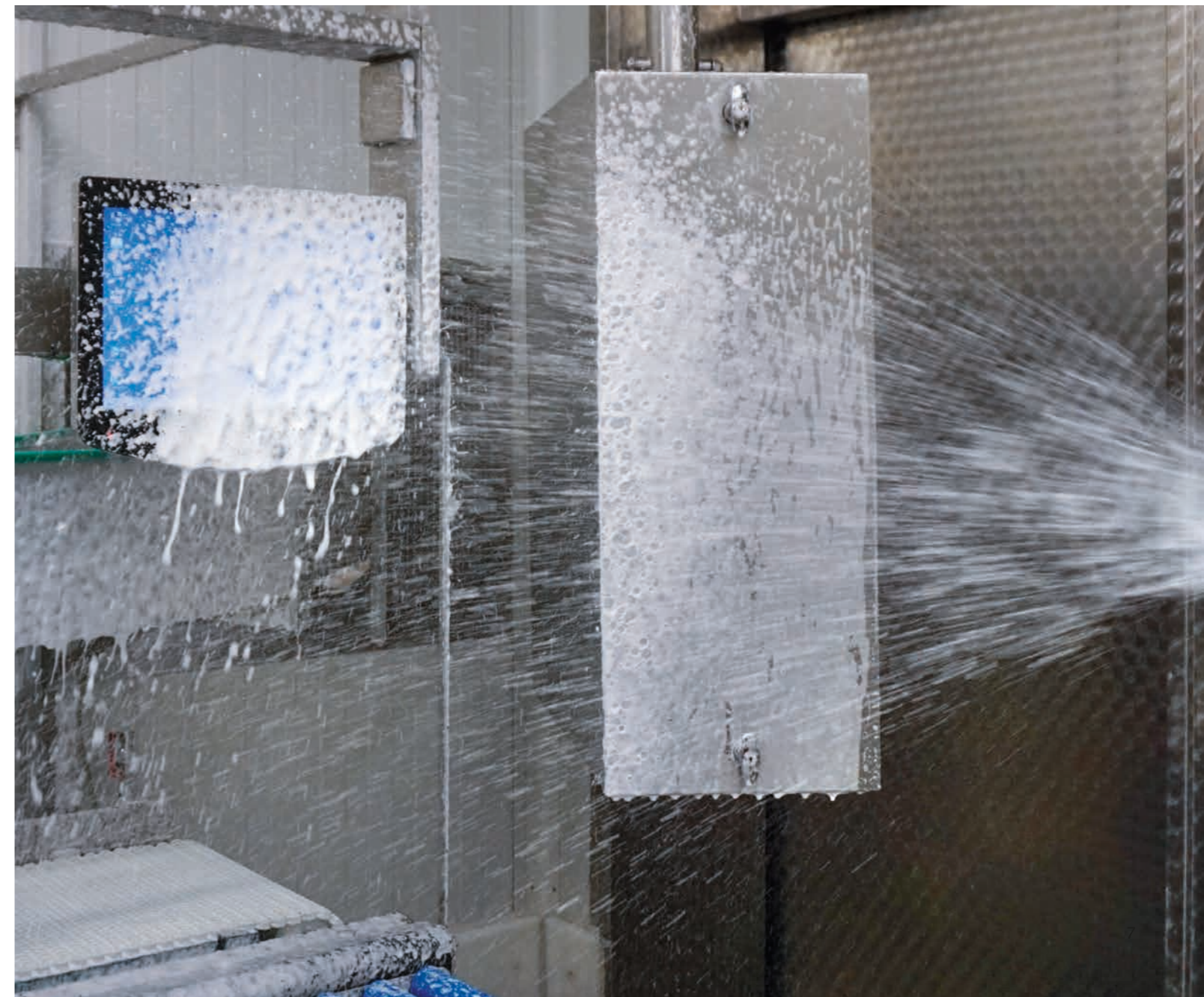

Excellent visualization and easy to operate

on P-CAP multi touch full HD displays



Full HD displays
Modern wide-screen displays
Anti-glare coating

Multifunctional button
> CCP Software (shortcuts, keyboard ...)
> On/Off button

P-CAP Multitouch

The P-CAP Multitouch offers an intuitive and convenient operation - similar to common modern touch pads and smartphones. Thus you can use drag & drop and multitouch functionalities such as zooming. The touch sensitivity, moreover, can be adjusted easily according to individual needs.

Full HD displays

Excellent visualization on modern full HD wide-screen displays.

Multifunctional button

The multifunctional button opens the CCP Software per default. The software can be configured entirely to meet personal needs. It includes per default a cleaning mode, a numblock and keyboard along with brightness control.



P-CAP Multitouch
Multiple inputs and drag&drop operations
Individual input sensitivity adjustment

Configurable Multi-Touch

individually adjustable for every glove type



The project highlights

- Plant visualization and monitoring with food IPCs in the production area
- Washing hall with high mechanical load for the HMIs
- Supplier registration via integrated RFID reader
- High hygiene requirements in the cheese production areas



Technical information

CS17 - 17" hygienic HMI



	CS17	
Dimensions	in mm (HxWxD) Weight (depending on the configuration)	315 x 447 x 64 mm 5,9 kg
Housing	Material: Impermeability:	V4A IP69k
Display	Diagonal Resolution Touchscreen Background lighting	17.3" 1920 x 1080 P-CAP incl. Water detection LED / 400 cd/m ²
CPU	Typ: Memory:	Intel® BayTrail Intel® Celeron Intel® Core i5 Intel® Core i7 up to 16 GB
Connections (depends on Board-Typ)	Ethernet: USB-Ports:	2 x 100/1000 Mbit up to 4 x USB 2.0 up to 2 x USB 3.0
Expansion cards	Expansion-Slots:	1 x Display Port 1 x SD-Card Slot 2 x Serial Port (RS-232/422/485)
Integrated RFID Reader		13,56 MHz Reader (Legic, Mifare ...) 125 kHz Reader (HITAG / em)
Microcontroller	Monitoring functions: Control tasks:	Power supply and temperatures Power management Touch controller Backlight
Environmental conditions	Ambient temperature Storage temperature Max. rel. humidity	-5°C (optional: -28°C) bis + 50°C -40°C to + 80°C 95 % at 40°C non-condensing
Power supply		12 / 24 V 230 VAC
Operating System		Microsoft Windows® 10/8/7 Linux and Android

Technical information

CS24 - 24" hygienic HMI



	CS24	
Dimensions	in mm (HxWxD) Weight (depending on the configuration)	400 x 597 x 69 mm 8,3 kg
Housing	Material: Impermeability:	V4A IP69k
Display	Diagonal Resolution Touchscreen Background lighting	23.8" 1920 x 1080 P-CAP incl. Water detection LED / 400 cd/m ²
CPU	Typ: Memory:	Intel® BayTrail Intel® Celeron Intel® Core i5 Intel® Core i7 up to 16 GB
Connections (depends on Board-Typ)	Ethernet: USB-Ports:	2 x 100/1000 Mbit up to 4 x USB 2.0 up to 2 x USB 3.0
Expansion cards	Expansion-Slots:	1 x Display Port 1 x SD-Card Slot 2 x Serial Port (RS-232/422/485)
Integrated RFID Reader		13,56 MHz Reader (Legic, Mifare ...) 125 kHz Reader (HITAG / em)
Microcontroller	Monitoring functions: Control tasks:	Power supply and temperatures Power management Touch controller Backlight
Environmental conditions	Ambient temperature Storage temperature Max. rel. humidity	-5°C (optional: -28°C) bis + 50°C -40°C to + 80°C 95 % at 40°C non-condensing
Power supply		12 / 24 V 230 VAC
Operating System		Microsoft Windows® 10/8/7 Linux and Android

Maximum IT-Security

due to fully integrated RFID / NFC readers



Identification with:
- Unique ID
- PC/SC Protocol / Windows-Logon
- PKI or Credential Provider

All interfaces are fully integrated in your operating system

Fully integrated RFID / NFC reader for Identification and control

Extract of applicable reader technologies

13.56 MHz Technology	125 kHz Technology
<ul style="list-style-type: none"> - Legic - Mifare - NTAG2xx - Calypso - CEPAS - Moneo - Sony FeliCa - HID iCLASS 	<ul style="list-style-type: none"> - HITAG 1, 2, S - EM4100, 4102, 4200 - EM4050, 4150, 4450, 4550 - EM4305 - Cotag - G-Prox, HID DuoProx II - HID ISO Prox II - HID Micro Prox - T5557, T5567, T5577 - AWID

Identification of staff

directly at the workstation in the production area



The project highlights

- Paperless recording of operating data with touchscreen IPCs in the production area
- Centralized recording of key data for enhanced quality management
- Time savings thanks to touchscreens that can be used with gloves
- Easy user and time management via integrated RFID reader
- Custom installation solution for a maximum in ergonomics and usability
- IPCs as basis for further developments in Internet of things (IoT)



Staff is identified directly in the production area with fully integrated readers in CAITRON's Industrial PCs

Implementation

easy and for many operating systems



Working environment

Compact and space-saving
Can be mounted by one person
Comfortable bayonet system
Loss-protected screws

Protected plug area
Standard cable can be used
Sealed cable outlet

Versatile Mounting Options – Custom Adaptations by Request.

Various mounting systems allow easy integration of the HMI, even where space is limited. Regardless whether wall mounts, tube systems, ceiling mounts, Rittal or VESA adapters – we will find solutions for the best implementation in your production environment.

Bayonet System

All mounting systems are compact and space saving. They also have a bayonet system for fast and easy mounting, which can be performed by only one person.



IT infrastructure

Integrated WLAN-Bluetooth® module
Integrated RFID / NFC reader
Integrated power supply unit

Operating system-independent:
Windows® 7/8/10, Linux, Android,
CITRIX®, IGEL®

Wireless connection

Built-in Wifi and Bluetooth® modules permit wireless connections to peripherals such as Barcode Scanners.

Open platform

The HMIs can be operated with several common operating systems ranging from Windows® 10 to Linux and Android.

Support arms

universally applicable



Protected plug area
Standard cable can be used
Sealed cable outlet

Various mounting options:
Wall mounts, support arm systems
Rittal adapter, table mounts...

Versatile and Operating System-Independent



Modular concept

right up to customer-specific workstations

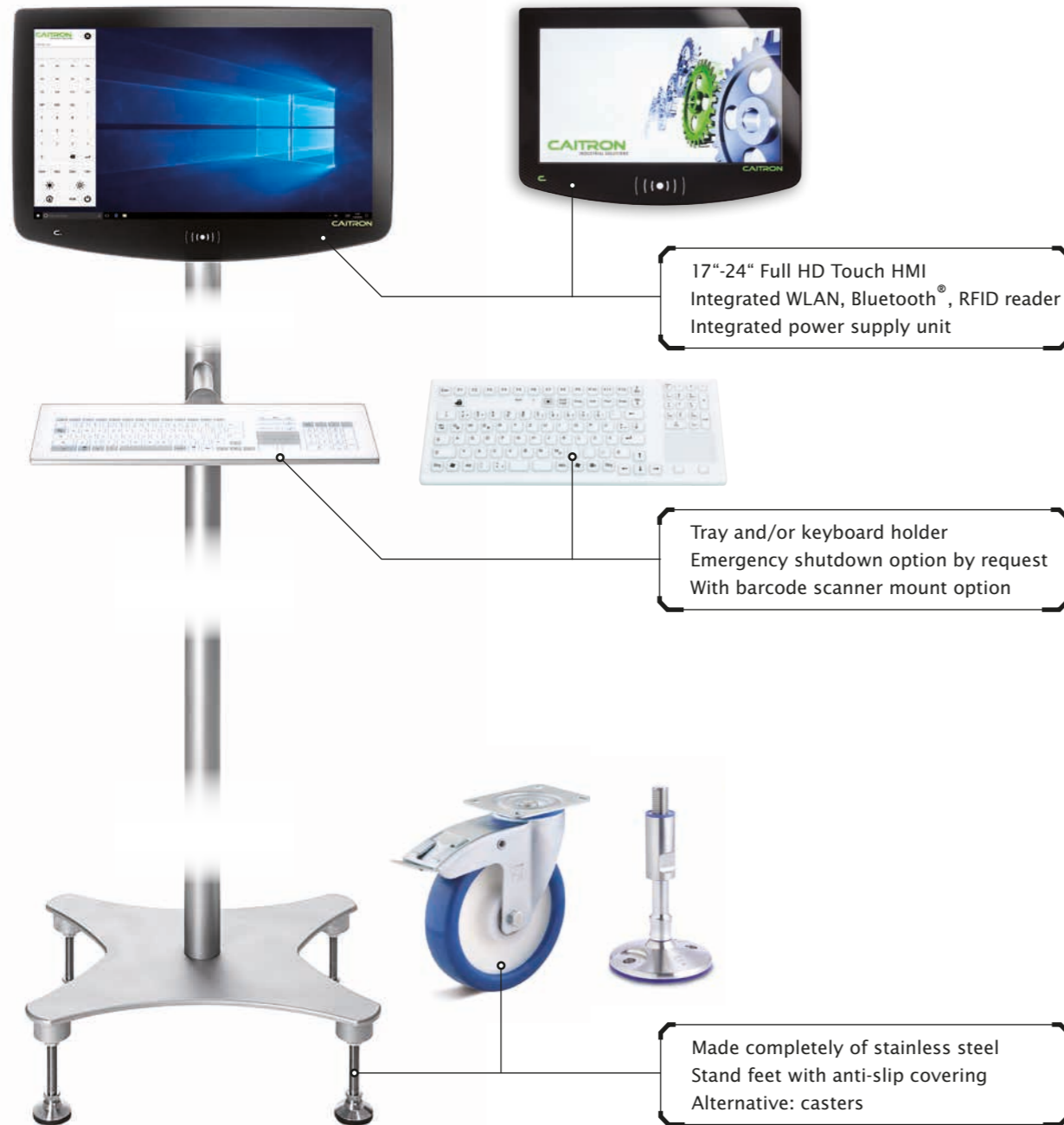

Customer-specific integration

in existing production architecture



The project highlights

- Easy implementation in the existing production architecture
- Compatibility with existing IT infrastructure (connections to printers and scales)
- Safe, fast and effective cleaning with high-pressure cleaners
- Modern operation (P-CAP multi-touch)
- Robust construction with components suitable for industrial use



Maximum operation safety

thanks to industry-specific development



Homogeneously sealed enclosure
Crevice-free seal and Protection rating
IP69k > water/dust proof

Industrial-strength components
Industrial CPU boards only
Chemically hardened front

High level of integration
Integrated WLAN / Bluetooth
Integrated reader (Legic, Mifare, HiTAG)

Completely passive cooling system
Without any ventilation slits > IP69k
No rotating parts > extremely fail-safe!

Homogeneously Sealed Enclosure

CS series products have IP69k protection, so they are completely water and dust proof.

Exclusive use of industrial components

CAITRON exclusively uses industrial CPU boards and components and parts from the embedded market. With its chemical hardening, the front is extremely robust. More protective films are available upon request.

High Level of Integration

Wifi, Bluetooth®, power supply unit and reader are integrated in the HMIs. In this way the kind of leak-tightness risks that can occur with external connections are avoided.

Completely Passive Cooling System

Systematically implemented climate management, low-voltage components and the elimination of rotating parts that are susceptible to malfunction (e.g. ventilators) ensure high resistance to breakdown.

Controlling and monitoring

reliably and directly in the production process



The project highlights

- Controlling and monitoring production with hygienic food IPCs
- Paperless production thanks to digital production instructions
- Recording of malfunctions via IPCs for further benchmarking
- Use of the IPCs with gloves thanks to P-CAP multi-touch technology
- Easy connection of barcode scanners to IPCs in the logistics area
- Convenient recording of time for staff at the IPCs, thanks to integrated LEGIC RFID readers



Additional equipment

Hygienic and detectable touch pen



Vulcanised EPDM tip
(optional: other materials such as FFKM
available on request)

Stainless steel shaft
High resistance to acids / alkalis
Smooth surfaces for easy cleaning



Additional equipment

Keyboards and Mouse

Hygienic Coating
Antimicrobial Coating (optional)
Smooth surfaces > easy to clean

Water- and dustproof (IP68)
Touch Pads & Mouse Buttons (optional)
Layouts in DE & US available



	InduProof Touch	InduProof Mouse Button
Number of keys	104	104
Key technology	Carbon contact	Carbon contact
Dimensions	340 x 165 x 16,3 mm	340 x 165 x 16,3 mm
Enclosure	Silicone	Silicone
Interface	USB	USB
Mouse replacement	Touch Pad (kapazitiv)	Mouse Button (Hall Sensor)
Degree of protection	IP68	IP68

Easy cleaning and disinfection
Water- and dustproof (IP68)

Ergonomic design
Optimised for right- and lefthanded
Two keys inclusive scroll-function



	InduMouse® Pro	TKH-Mouse Med
Number of keys	5	5
Enclosure	Silicone	Silicone
Key technology	Short-stroke keys	Switching cycles 2 million per key
Scanning	Infrared	Laser
Degree of protection	IP68	IP68
Interface	USB	USB

Personal Support

Ranging from implementation to special adaptations

Individual Support

We support you in everything from implementation to individual reader adaptations.

Free Test Devices

Try out our products in advance – free and non-binding!

24/7 Service

We prefer direct contact, so we have no call center.

Regardless whether it's in the middle of the night, on the weekend, or on holidays – our service department will be glad to help.

Immediate Replacement

In emergencies we won't hold you up with formalities but will send you a replacement immediately.



... at any time > www.caitron.de

CAITRON

INDUSTRIAL SOLUTIONS

CAITRON GmbH
Eich 8
D-83561 Ramerberg

fon: +49 (0) 80 39 - 900 900 0
fax: +49 (0) 80 39 - 900 900 9

web: www.caitron.de
email: info@caitron.de