

Portfolio

Solutions for cleanroom applications



Product overview

Individual clean room solutions and optional configurations



Universal arm systems

Laboratory workplace

Workstations

Input devices



Cleanroom Design

smooth surfaces and high chemical resistance



Effective and Safe Cleaning

By systematically eliminating frames and welded seams our products in the CR series have a completely smooth and easy-to-clean surface, without any joints or grooves. The IPC's enclosure is beveled towards the back so that liquids can flow off and do not accumulate on the enclosure's upper edge.

High chemical resistance of all materials

The materials used have a high resistance to industry-standard disinfectants and cleaning agents. Individual tests for special chemical substances are possible in cooperation with the Fraunhofer Institut Stuttgart.

High Level of Integration

Integrated in the IPCs are WLAN, Bluetooth®, a power supply unit and a reader (RFID/NFC). In this way the kind of hygiene and leak-tightness risks that can occur with external connections are avoided.

Low emission materials

All materials used have low emission values. For particularly demanding requirements, FFKM and other materials are also available.

Excellent visualization and easy to operate

on P-CAP multi touch full HD displays 17-24"

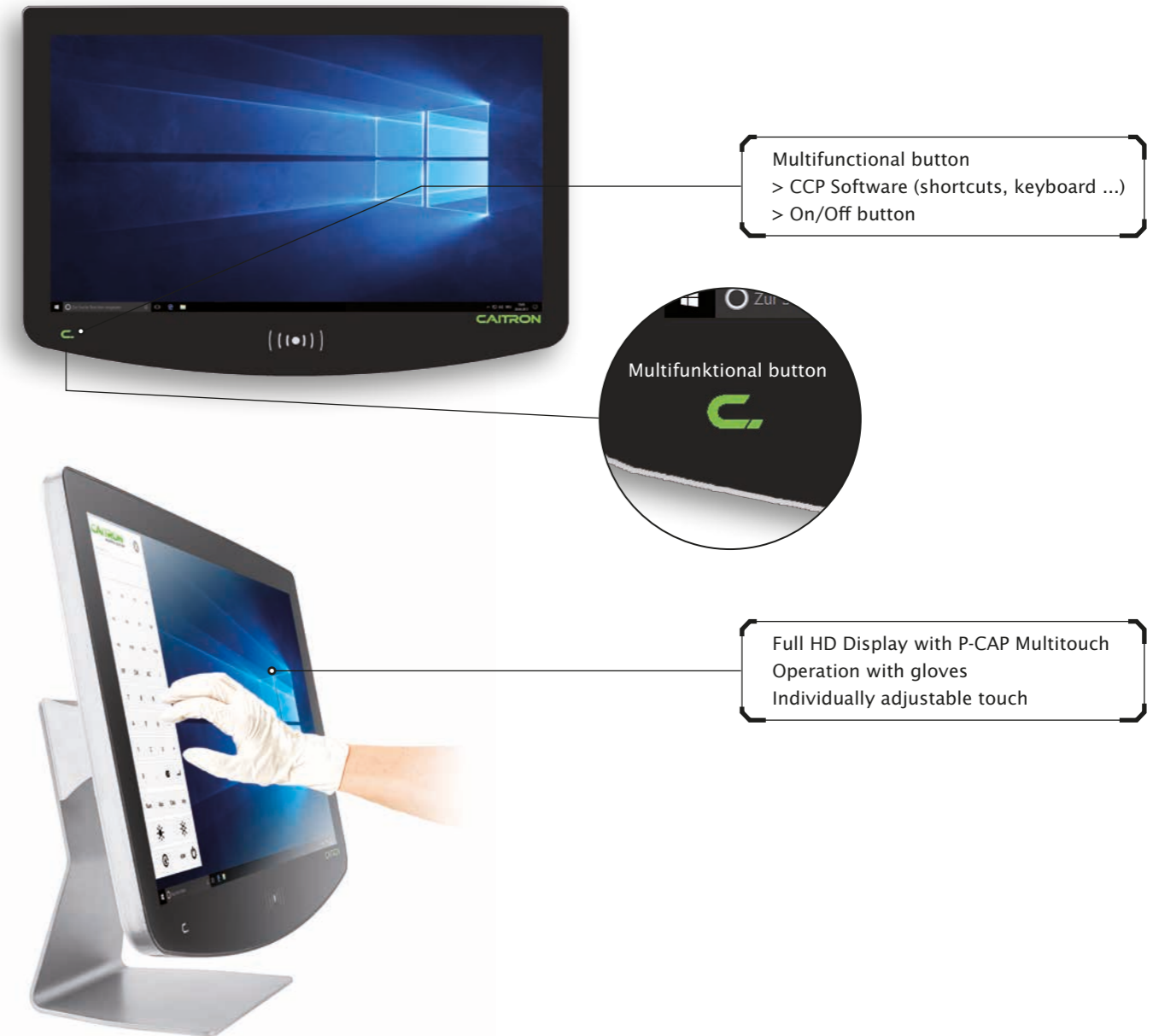

P-CAP Multitouch

The P-CAP Multitouch offers an intuitive and convenient operation - similar to common modern touch pads and smartphones. Thus you can use drag & drop and multitouch functionalities such as zooming. The touch sensitivity, moreover, can be adjusted easily according to individual needs.

Full HD displays

Excellent visualization on modern full HD wide-screen displays.

Multifunctional button

The multifunctional button opens the CCP Software per default. The software can be configured entirely to meet personal needs. It includes per default a cleaning mode, a numblock and keyboard along with brightness control.

Safe use up to GMP class A / B

Certified by Fraunhofer Institute - Tested Device

Highest level of hygiene safety

KIN-Hygienic-Conformity - for the use in hygienically sensitive areas



Fraunhofer

TESTED[®] DEVICE

CAITRON GmbH
Cleanroom HMI CR-series
Report No. CA 2005-1157

Product series
Hygienic Design

Qualification Certificate

This is to certify that the product mentioned above, provided by
CAITRON GmbH
Ramerberg, Germany

has been awarded a Fraunhofer certificate TESTED DEVICE bearing the report number CA 2005-1157.

The Cleanroom HMI CR-series is principally suitable for use in hygienic areas up to the following GMP Class according to EU GMP Annex 1:

Suitability
up to GMP Class A / B

However, this recommendation only pertains to the operating utility when in a resting state. An overall assessment can only be made after its installation in the production line.

DUPLICATE

This document only applies to the named product in its original state and is valid for a period of 5 years from the date the first document was issued. The document can be verified under www.tested-device.com.

Detailed information and parameters of the test environment can be found in the Fraunhofer IPA test report.

CA 2005-1157
Report No. first document

--
Report No. current document

Stuttgart, July 3, 2020
Place, date of first document issued

--
Place, current date

on behalf of 
Dr.-Ing. Frank Bürger, Project Manager Fraunhofer IPA





ZERTIFIKAT

Industrial HMI – CAITRON GmbH

- CX Series | 17" HMI | Serial Coding: CAPPx17xx-00000 | Tested sample: 17PP285-G
- CS & CR Series | 17" HMI | Serial Coding: CAPPx17xx-00000 | Tested sample: 17PP285-H
- CS & CR Series | 24" HMI | Serial Coding: CAPPx24xx-00000 | Tested sample: 17PP236-A

The systems mentioned above are particularly suitable for operation in hygienically sensitive production environments such as the food and pharmaceutical industries. The special requirements for hygiene and product safety / process safety are guaranteed by the following criteria:

- Smooth surfaces
- Dust and water proof housings
- high resistance against acids and alkalis
- No open unprotected connections
- High thermal resistance at 90...
- High impact resistance

Lebensmittelinstitut KIN e. V.

Lehrgangsleitung
Beate Vogelsang



Neumünster, 26. September 2019

Technical information

CR17 - 17" Hygienic HMI



	CR17	
Dimensions	in mm (HxWxD) Weight (depending configuration)	315 x 447 x 64 mm 5,9 kg
Housing	Material: Impermeability:	V4A IP69k
Display	Diagonal Resolution Touchscreen Background lighting	17.3" 1920 x 1080 P-CAP incl. Water detection LED / 400 cd/m ²
CPU	Typ: Memory:	Intel® BayTrail Intel® Celeron Intel® Core i5 Intel® Core i7 up to 16 GB
Connections (depends on Board-Typ)	Ethernet: USB-Ports:	2 x 100/1000 Mbit up to 4 x USB 2.0 up to 2 x USB 3.0
Expansion cards	Expansion-Slots:	1 x Display Port 1 x SD-Card Slot 2 x Serial Port (RS-232/422/485)
Integrated RFID Reader		13,56 MHz Reader (Legic, Mifare ...) 125 kHz Reader (HITAG / em)
Microcontroller	Monitoring functions: Control tasks:	Power supply and temperatures Power management Touch controller Backlight
Environmental conditions	Ambient temperature Storage temperature Max. rel. humidity	-5°C (optional: -28°C) bis + 50°C -40°C to + 80°C 95 % at 40°C non-condensing
Power supply		12 / 24 V 230 VAC
Operating System		Microsoft Windows® 10/8/7 Linux and Android

Technical information

CR24 - 24" Hygienic HMI



	CR24	
Dimensions	in mm (HxWxD) Weight (depending configuration)	400 x 597 x 69 mm 8,3 kg
Housing	Material: Impermeability:	V4A IP69k
Display	Diagonal Resolution Touchscreen Background lighting	23.8" 1920 x 1080 P-CAP incl. Water detection LED / 400 cd/m ²
CPU	Typ: Memory:	Intel® BayTrail Intel® Celeron Intel® Core i5 Intel® Core i7 up to 16 GB
Connections (depends on Board-Typ)	Ethernet: USB-Ports:	2 x 100/1000 Mbit up to 4 x USB 2.0 up to 2 x USB 3.0
Expansion cards	Expansion-Slots:	1 x Display Port 1 x SD-Card Slot 2 x Serial Port (RS-232/422/485)
Integrated RFID Reader		13,56 MHz Reader (Legic, Mifare ...) 125 kHz Reader (HITAG / em)
Microcontroller	Monitoring functions: Control tasks:	Power supply and temperatures Power management Touch controller Backlight
Environmental conditions	Ambient temperature Storage temperature Max. rel. humidity	-5°C (optional: -28°C) bis + 50°C -40°C to + 80°C 95 % at 40°C non-condensing
Power supply		12 / 24 V 230 VAC
Operating System		Microsoft Windows® 10/8/7 Linux and Android

Maximum IT-Security

due to fully integrated RFID / NFC readers



Identification with:
- Unique ID
- PC/SC Protocol / Windows-Logon
- PKI or Credential Provider

All interfaces are fully integrated in your operating system

Fully integrated RFID / NFC reader for Identification and control

125 kHz Technology
- HITAG 1, 2, S
- EM4100, 4102, 4200
- EM4050, 4150, 4450, 4550
- EM4305
- Cotag
- G-Prox, HID DuoProx II
- HID ISO Prox II
- HID Micro Prox
- T5557, T5567, T5577
- AWID

13.56 MHz Technology
- Legic
- Mifare
- NTAG2xx
- Calypso
- CEPAS
- Moneo
- Sony FeliCa
- HID iCLASS



High connectivity

All clean room HMIs of the CR series have various integrated interfaces for easy integration into the existing IT infrastructure. Fully integrated WLAN / BT and integrated RFID / NFC technology also enable wireless connection.

Operation-independent platform

The HMI of the CR series are completely independent of the operating system.

Support arms

universally applicable



Protected plug area
Standard cable can be used
Sealed cable outlet

Various mounting options:
Wall mounts, support arm systems
Rittal adapter, table mounts...

Versatile and Operating System-Independent



Wall mounting

individually adaptable - with and without keyboard holder



Various adaptation options for keyboard and barcode scanner holder



Laboratory workplace

including cable duct with GMP A / B certification



Smooth rounded surfaces
EHEDG certified hygienic screws
EHEDG certified rotary handles



IP69 protection - antistatic cable routing
(individually adaptable)
Wireless connections thanks to Bluetooth

Modular Concept

right up to customer-specific workstations



17"-24" Full HD Touch HMI
Integrated WLAN, Bluetooth®, RFID reader
Integrated power supply unit



Tray and/or keyboard holder
Emergency shutdown option by request
With barcode scanner mount option



Made completely of stainless steel
Stand feet with anti-slip covering
Alternative: casters

Additional equipment

Keyboards and mouse

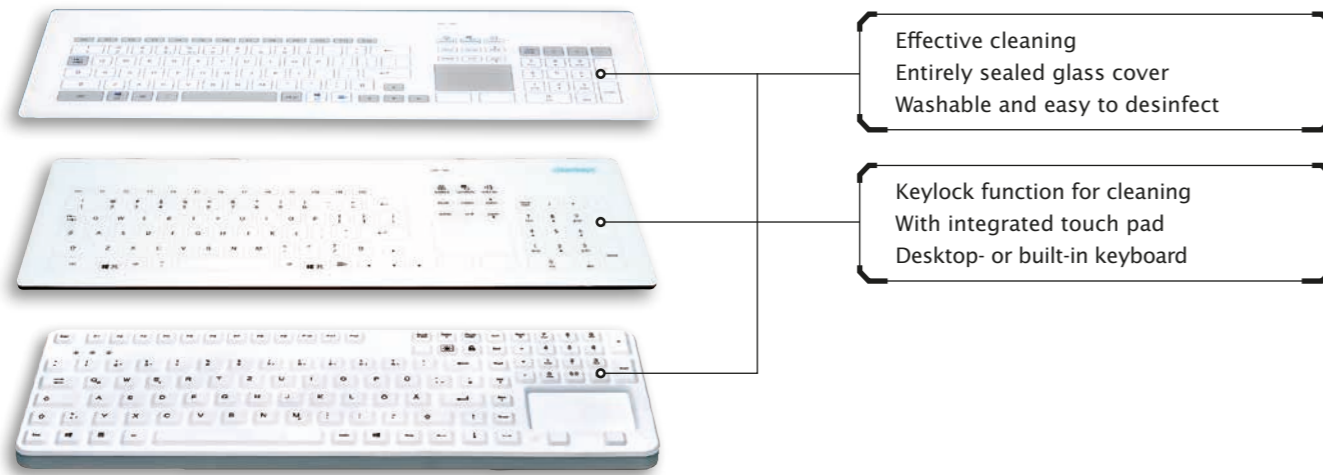

	CK4	CK4W	CleanType® Prime Touch+
Surface	0,8 mm glass	0,8 mm glass	Silicone
Enclosure	Plastic	Plastic	Silicone
Dimensions	470 x 167 x 25,4 mm	470 x 167 x 25,4 mm	365 x 134 x 14,2 mm
Impermeability	IP65 front	IP65 front	IP68
Key technology	capacitive	capacitive	capacitive
Number of keys	103	103	109
Cursor control	Touchpad	Touchpad	Touchpad
Interface	USB	USB (USB-Dongle)	USB

Additional equipment

Keyboards and Mouse

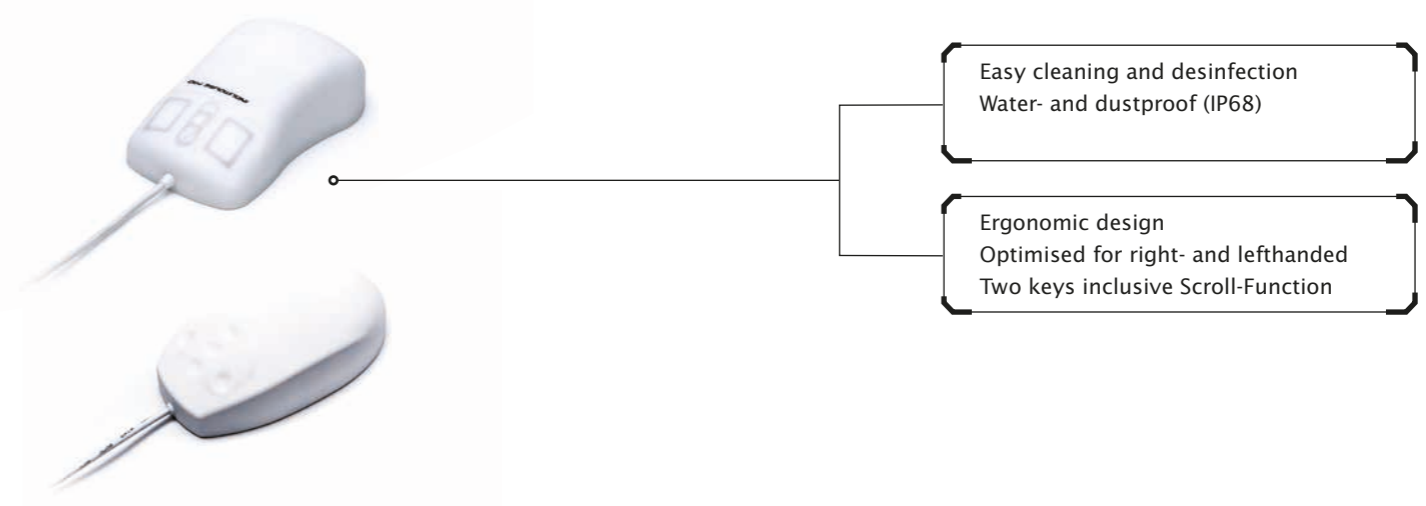

	InduMouse® Pro	TKH-Mouse Med	Cleankeys® CKM2W
Number of keys	5	5	2 plus scroll wheel
Enclosure	Silicone, Plastic	Silicone	Plastic - ABS
Scanning	Infrared	Laser	optical (LED)
Scrollfunction	3 scroll keys	click-scroll keys	Scroll wheel
Degree of protection	IP68	IP68	IP68 (enclosure)
Interface	USB	USB	USB
Working Temperature	0°C to +40 °C	-30°C to +70 °C	-15°C to +60°C
Dimensions	115 x 61 x 39 mm	105 x 60 x 37 mm	117 x 65 x 37,5 mm
Weight	150 g	170 g	Mouse 80 g – Station 140 g

Additional equipment

Hygienic and detectable touch pen



Vulcanised EPDM tip
(optional: other materials such as FFKM
vailable on request)

Stainless steel shaft
High resistance to acids / alkalis
Smooth surfaces for easy cleaning



Additional equipment

CAITRON App



Freely configurable toolbar
HMI information at a glance
Cleaning mode

Individually assignable buttons
> Keyboard inputs
> Function commands

NumBlock and ABC keyboard
calculator
Alternatively: freely configurable

HMI information at a glance

```

Info
-----
ComputerName: DESKTOP-TDMGF54
SerialNumber: CAPP2455-00202
-----
BIOS Version      1.10 - American Megatrends Inc.
DiskDrive         JetFlash Transcend 32GB USB Device
DiskDrive         TS128GMTS400
Manufacturer      CAITRON GmbH
Model             CAITRON IPC
Network           Intel(R) Ethernet Connection I218-LM
Network           Intel(R) I211 Gigabit Network Connection
OS-Version        Microsoft Windows 10 Pro
Processor          Intel(R) Core(TM) i5-5350U CPU @ 1.80GHz
RAM               8.507.641.856
User              DESKTOP-TDMGF54\Administrator
UUID              6E032C18-7322-11EA-80AB-BF987AC57B94
    
```

Cleaning mode
> Deactivates all inputs
> Convenient wipe cleaning

Personal Support

Ranging from implementation to special adaptations

Individual Support

We support you in everything from implementation to individual reader adaptations.

Free Test Devices

Try out our products in advance – free and non-binding!

24/7 Service

We prefer direct contact, so we have no call center.

Regardless whether it's in the middle of the night, on the weekend, or on holidays – our service department will be glad to help.

Immediate Replacement

In emergencies we won't hold you up with formalities but will send you a replacement immediately.



... at any time > www.caitron.de

CAITRON

INDUSTRIAL SOLUTIONS

CAITRON GmbH
Eich 8
D-83561 Ramerberg

fon: +49 (0) 80 39 - 900 900 0
fax: +49 (0) 80 39 - 900 900 9

web: www.caitron.de
email: info@caitron.de